

Proposed Siting of your Wisdom Home



Wisdom Properties Group Pty Ltd | 17-19 Central Hills Drive Gregory Hills NSW 2557 | Phone: (02) 4647 1200 | www.wisdomhomes.com.au

Customer: Wisdom H& L Package

Date: 03/10/2023

Site Address: Lot 107 Proposed Rd

Estate:

Locality: CHISHOLM (2322) NSW

Planning: CDC - NSW GREENFIELDS HOUSING CODE

Home Design: SERENITY 26 PORTICO

DP Number: 107/DP999725

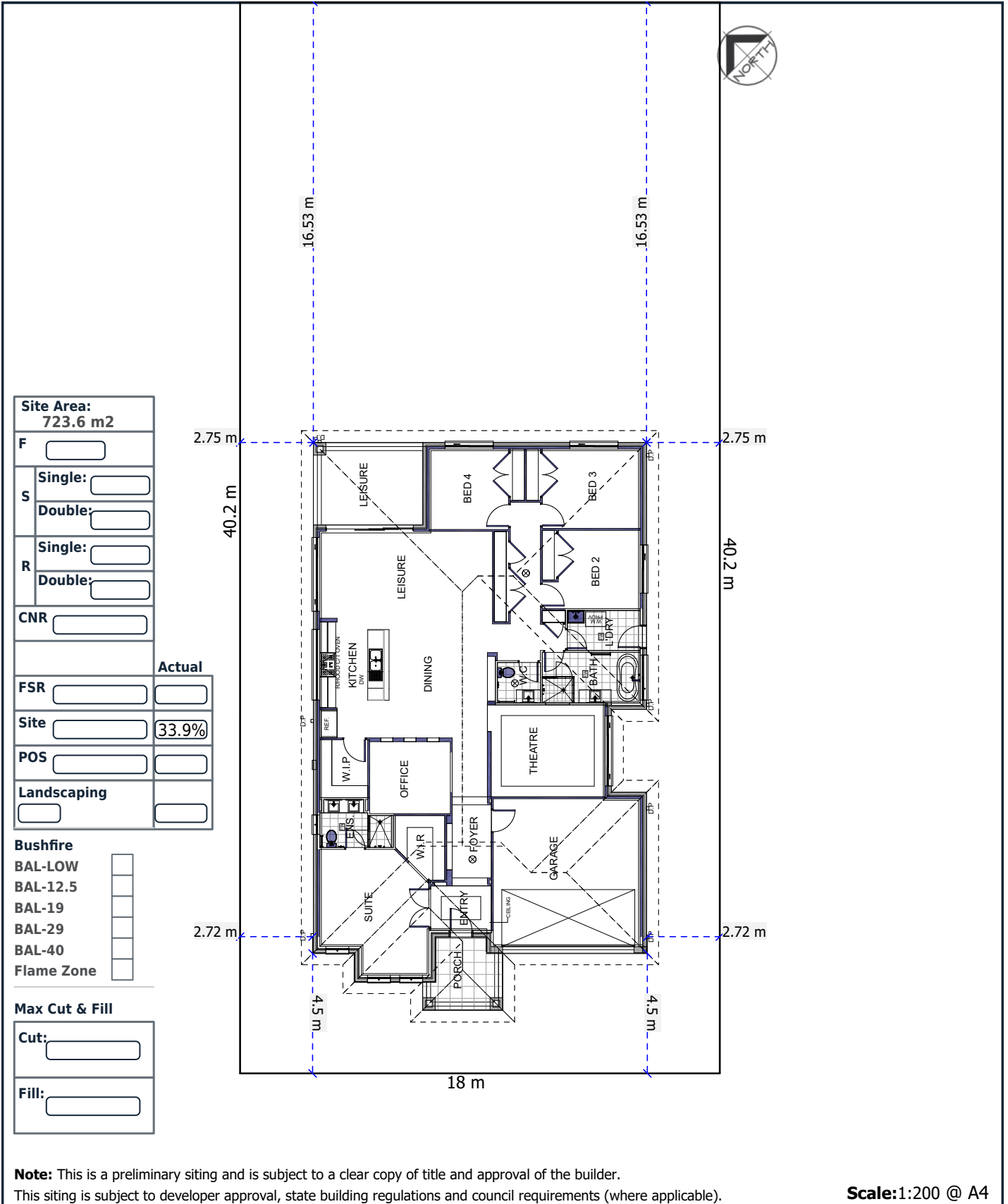

Note: This is a preliminary siting and is subject to a clear copy of title and approval of the builder. This siting is subject to developer approval, state building regulations and council requirements (where applicable).

Scale: 1:200 @ A4

Consultant: Jessa Watson

Email: jessaw@wisdomhomes.com.au

(Geo Plan ID: 546273)

© GeoSite IT Pty Ltd

Customer Signature (1)

Date (1)

Customer Signature (2)

Date (2)